

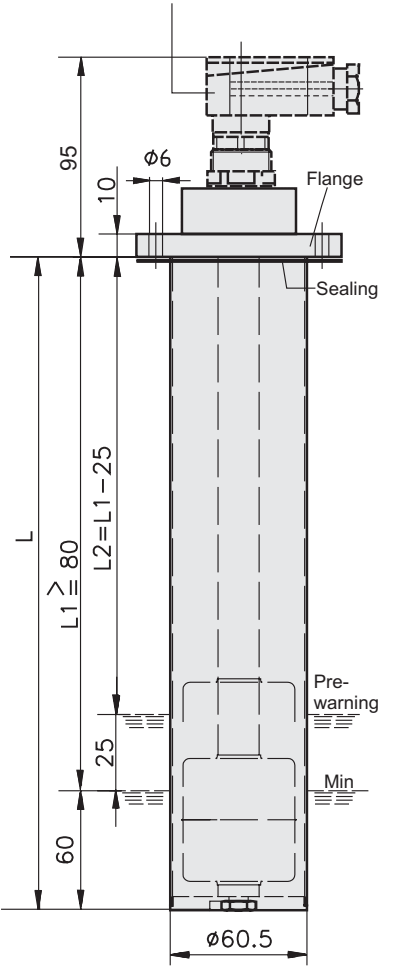

KFR-C with surge protection

Plug-in connection DIN 43651 part 2 (see DBL 9666 EA) with LED (not part of the delivery extent)



Wiring diagram Z5A

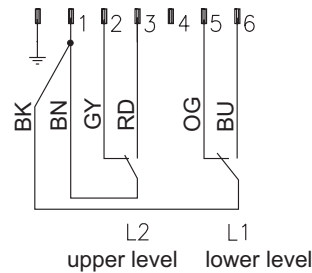
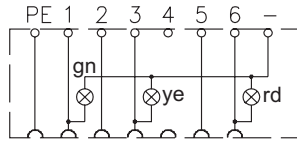

Drill pattern

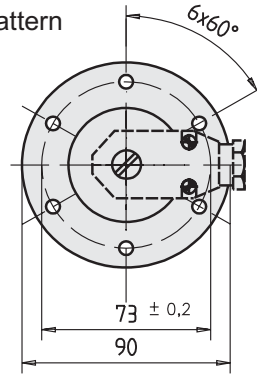

Plug-in connection with LED-inset if require:
 Plug-in connection 913.400-36
 LED-inset 913.400-39

Level switch KFR-C

- Plug-in connection DIN 43651
- Change-over contact bistable
- Two switching points for pre-warning

Application:

For the detection of liquid levels in reservoirs.

Function:

In the lower end of the conductor pipe there are two Reed contacts having a difference distance of 25mm for pre-warning and disconnection. The switching function is bistable. The plug-in connection with LED-inset is not part of the delivery extent.

Technical Data - General:

Operating pressure max: 10 bar
 Temperature range: 0...90 °C
 Mounting position: vertically ± 20 °
 Material:
 Internal pipe D 18: CU-alloy
 External pipe D 60: Al-alloy
 Flange: Al-alloy
 Float: 1.4571
 Sealing: Abil
 Protection type: IP 65
 Protection class: I
 Plug-in connection: DIN 43651
 Flange: drilling scheme DIN 24557 part 2
 Weight at L1 = 300: 0,45 kg

Technical Data - Reed Contacts:

Switching voltage:
 normally 10...230 VUC
 with LED-inset 18...30 VDC
 Switching current max.: 1 A
 Switching power max.: 40/60 W/VA
 For inductive and capacitive loads, suppressor circuits shall be provided for. (Diode, RC element, varistor)

- Subject to modifications -

Order designation:

Level switch



Flange	Float	Surge protection	Switching functions		Plug-in connection	Length		
			L1 Switching point down	L2 Switching point pre-warning		L [mm]	L1 [mm]	L2 [mm]
(F6) 6 bore-holes	(B) Stainless steel	with (M)	Change-over difference 25mm (W25)	Change-over difference 25mm (W25)	DIN43651 (Z5A)	215	155	130*
						346	286	261**
						state in the order		

* =05.4.3.3-A Daimler Chrysler-BV } The plug-in connection with LED-inset is not part of the delivery extent.
 **=05.4.3.3-B Daimler Chrysler-BV }