

Level Switch KFE-A

- Plug-in connection 4pol. M12x1 for sensors
- One or two switching points

Application:

For the detection of liquid levels in reservoirs.

Function:

One or two reed contacts are switched by a permanent magnet in a float. In the respective switching position, float overdrive is inhibited.

Technical Data - General:

Operating pressure max.:	
Float type B	4 bar
Float Type C	1 bar
Temperature range:	-20...+90 °C
Mounting position:	vertical ± 20 °
Material:	
Tube:	copper alloy
Float type B:	1.4571
Float type C:	polyurethane
Flange:	aluminium alloy
Seal:	Abil
Protection type:	IP 67
	(depending on cable jack)
Plug-and socket connection:	M12x1; 4pol
Weight at L=300:	0,3kg
Technical Data - Reed contacts:	
Switching voltage max.:	30 VDC
Switching current max.:	1,0A
Switching capacity max.:	40/60 W/VA

For inductive and capacitive loads, suppressor circuits shall be provided for. (Diode, RC element, varistor)

- Subject to modifications -

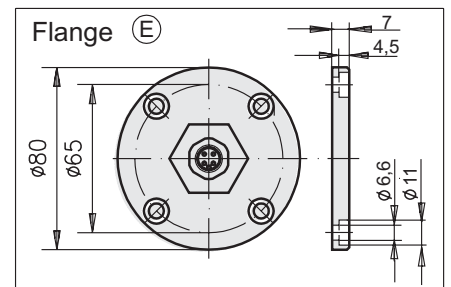
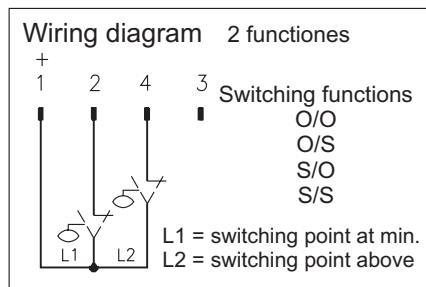
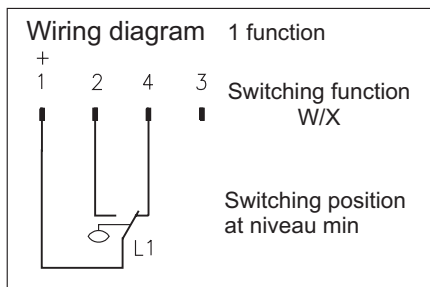

Order designation:

Level switch



Flange	Float	Switching functions		Switching length		Supplement-cable socket
		L1 descending level	L2 descending level	L1 [mm]	L2 [mm]	
D80/65 (E)	Stainless steel Ø 51 (B)	D.T. switch (changeover switch) (W)	without (X)		without (X)	without (N)
M20x1,5 (F)	Polyurethane Ø 45 (C)	Opener (O)	Opener (O)			
		Closer (S)	Closer (S)			